



a xylem brand



a xylem brand

Instruction Manual

BE/R 170

Pipe fixture

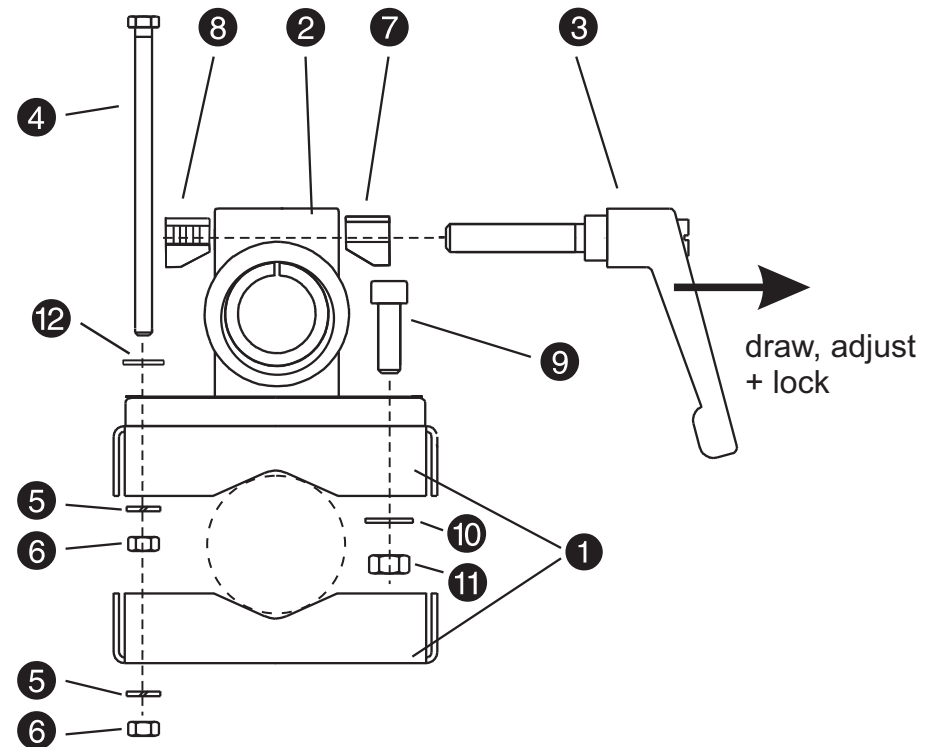

1725 Brannum Lane
Yellow Springs, Ohio 45387 USA
+1 937-767-7241
800-765-4974 (US)
FAX (937) 767-1058
Email: environmental@ysi.com
Internet: www.ysi.com

Assembly

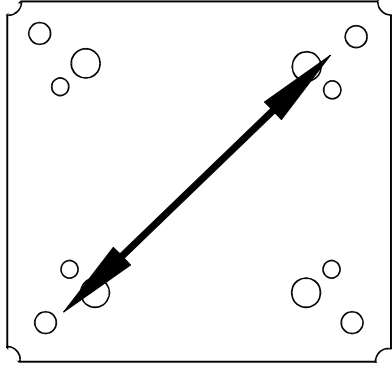

- For **easy assembly** pre-assemble two hexagon head screws **4** with lock washer **12**, spring washer **5** and nut **6** diagonally at one clamping shell.
- Assemble flange shim **2** with cheese-head screws **9**, shims **10** and nuts **11** (each 4 times) to the clamping shell.
- Assemble clamping lever **3**.
- Fix both clamping shells at the tube as shown in the drawing.

BE/R 170

BE/R 170

Equipment consists of

Position Article Quantity

1 Clamping shell 2

2 Flange shim with reducer 1

3 Clamping lever M8 x 50 1

4 Cheese-head screw M6 x 110 4

5 Spring washer 6.5 6

6 Nut DIN 934 M6 6

7 Clamping wedge without thread 1

8 Clamping wedge with thread 1

9 Cheese-head screw M8 x 25 4

10 Shim 8.4 4

11 Nut M8 4

12 Lock washer A 6.4 4

Materialsf

Position

Material

1 - **12**

Stainless steel 1.4301

2

Aluminium die-cast

3

Aluminium die-cast / Stainless steel 1.4301